

“ANNEX 1”

CONCEPTUAL DESIGN OF THE NEW
PEZA-MEZ
ADMINISTRATION
BUILDING

WORLD-CLASS BUSINESS INVESTMENT CENTER AND MODEL FOR SUSTAINABLE
DEVELOPMENT IN THE PHILIPPINES

“ANNEX 1”

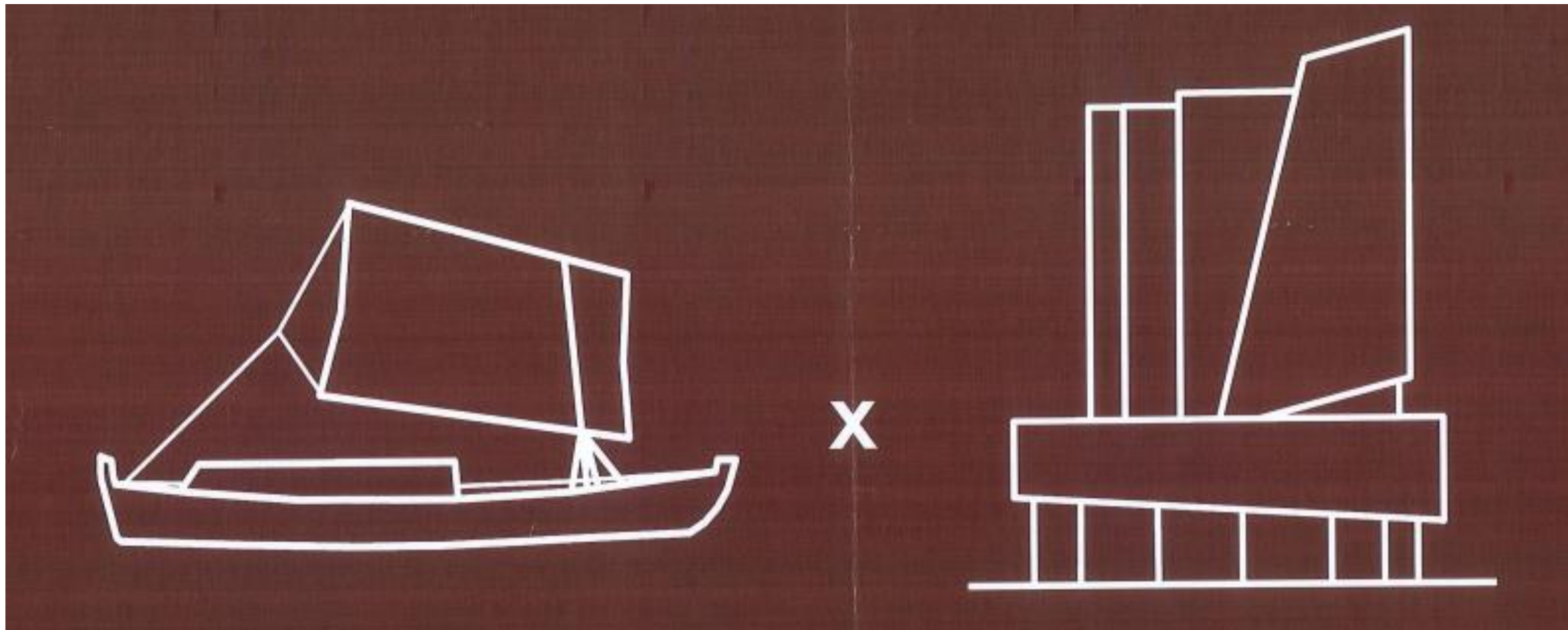

“BALANGAY”

One of the earliest modes of transportation instrumental to trading among Islands In the Southeast Asia, the **balangay** is a symbol of the **Filipino Ingenuity** in **finding ways to thrive** and **building relationship** among its nearby nations.



PEZA plays an important role in the trading and economic development.

The **balangay** would not only represent PEZA’s function to promote **trading**, but also would become a **symbol** of its mission and vision in promoting **sustainable development** and a balanced **economic and social development** in the country.

“BALANGAY”

The **balangay** comprises of several parts with notable elements that can likened to the proposed facility.

MAIN BODY: Foundation and Building

KATIG AND BATANGAN: Structural Stability

LAYAG: Façade

GAOD: PEZA Employees

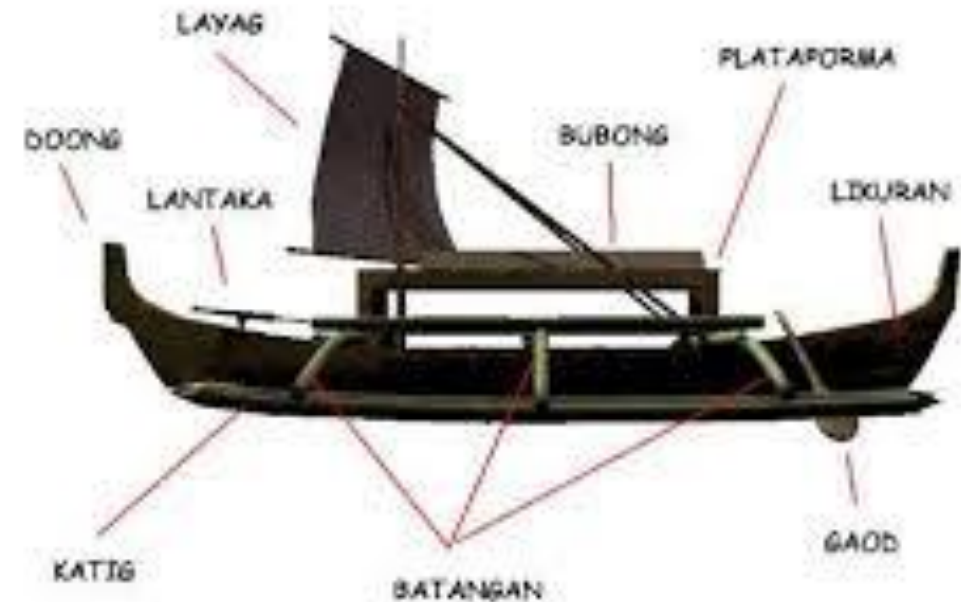

DESIGN FEATURES

PROTECTIVE LOUVERS: Resembling the balangay’s sail and serves as heat protection without completely obstructing the existing view from within the building

LIGHT COLORS: Reduce the albedo effect and could potentially offset some of the anticipated temperature increase warming.

LOW EMISSIVITY GLASS: Reduce amount of infrared and ultraviolet light

LANDSCAPING: Buffer for noise and pollution

POCKET PARK / OUTDOOR GARDEN: Contributes to the cooling effect and to promote breathable spaces

DESIGN FEATURES

SOLAR AND RAINWATER HARVESTING: Contribute to the efficiency of utility systems of the building while reducing energy and water consumption

SMART SYSTEMS: Occupancy sensors to automatically control the lighting system

EFFICIENT WATER FIXTURES: Modulates use of potable water

STEEL STRUCTURE: 30-60% lighter than a similar one made from concrete and requires less materials for its foundation.

With these sustainable considerations, the design and construction contributes to the **waste and carbon footprint reduction.**

"ANNEX 1"

SITE DEVELOPMENT PLAN

FOR FUTURE CONSTRUCTION OF
MEZ MULTI-PURPOSE BUILDING

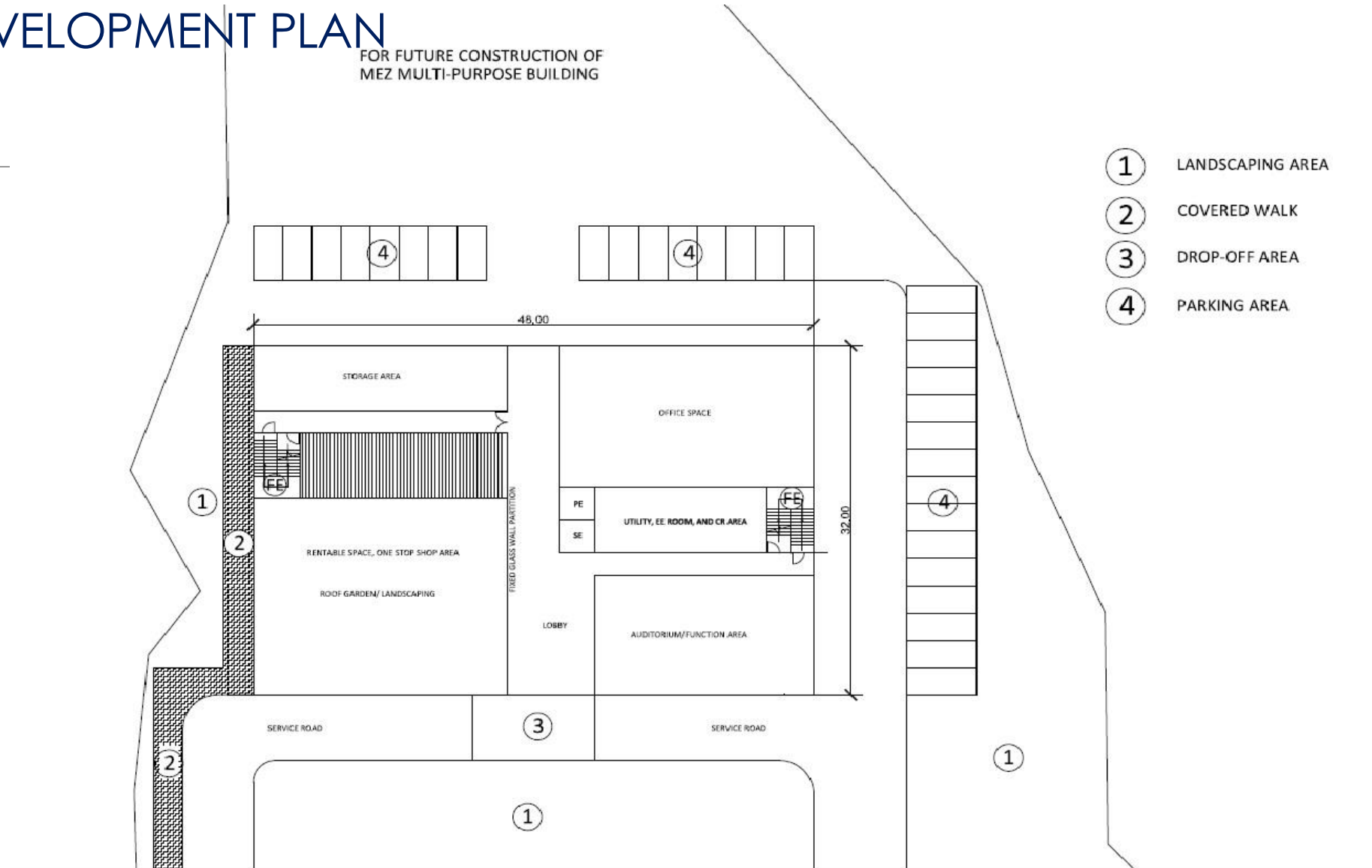

"ANNEX 1" GROUND FLOOR PLAN

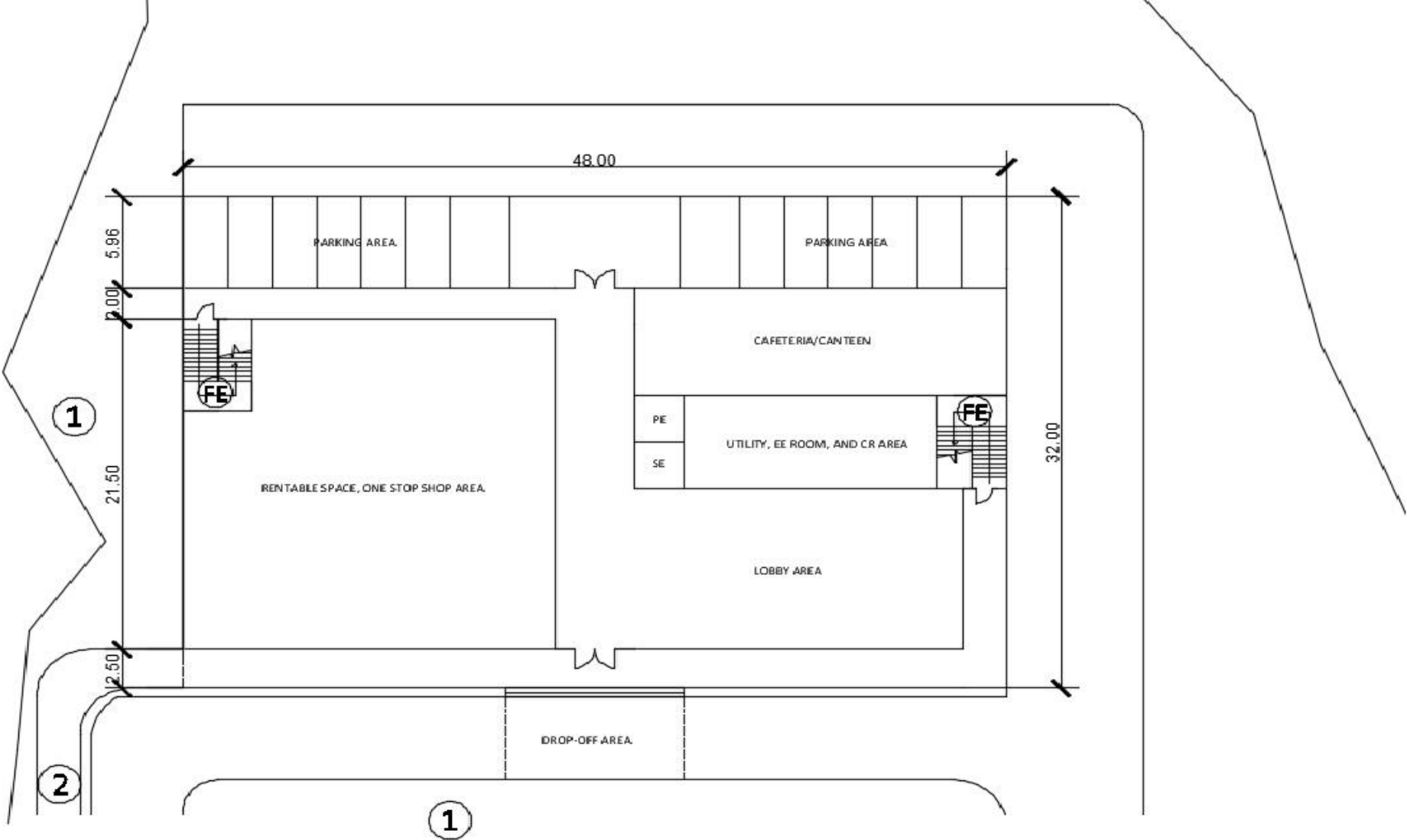

"ANNEX 1" SECOND FLOOR PLAN

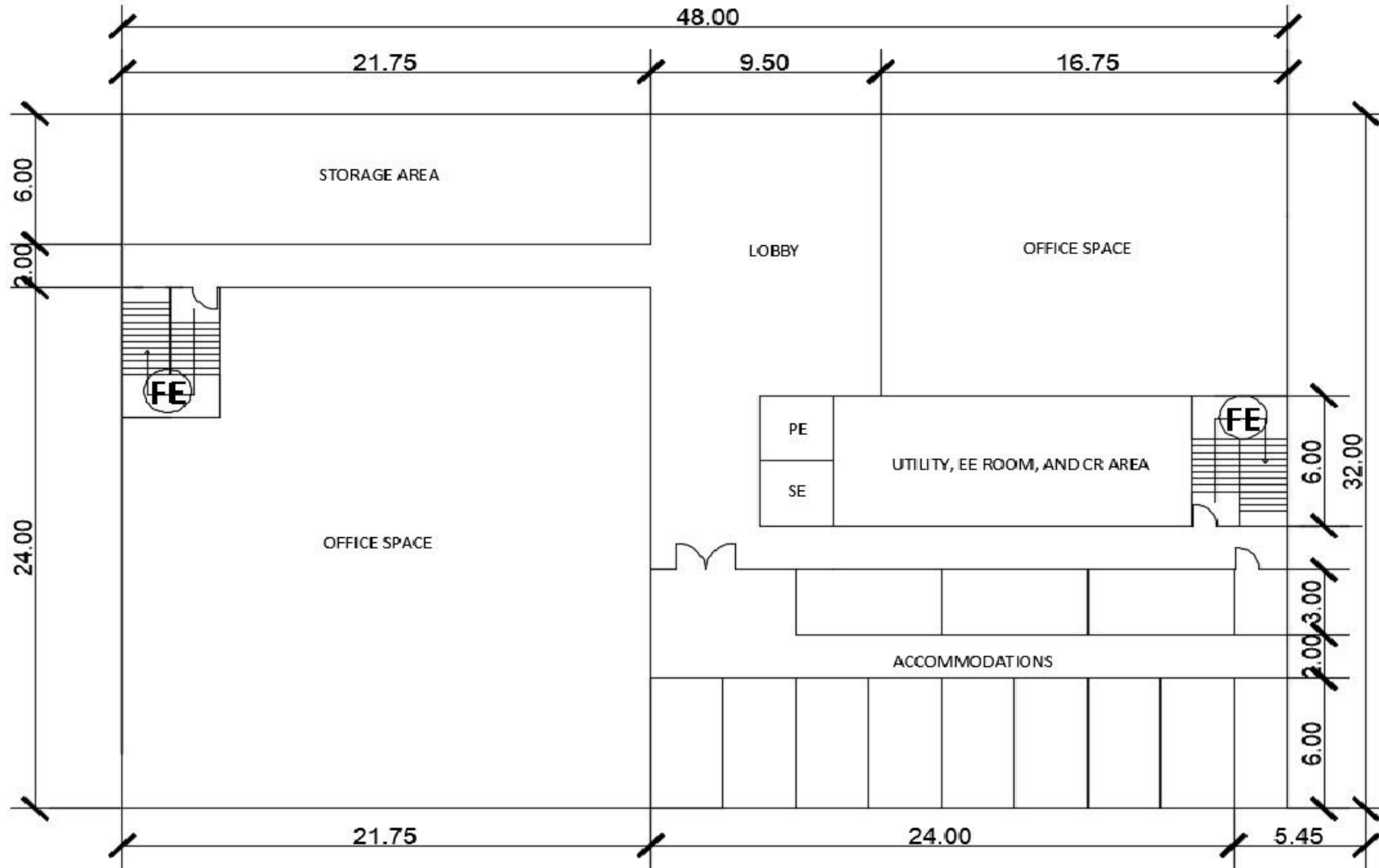

"ANNEX 1" THIRD FLOOR PLAN

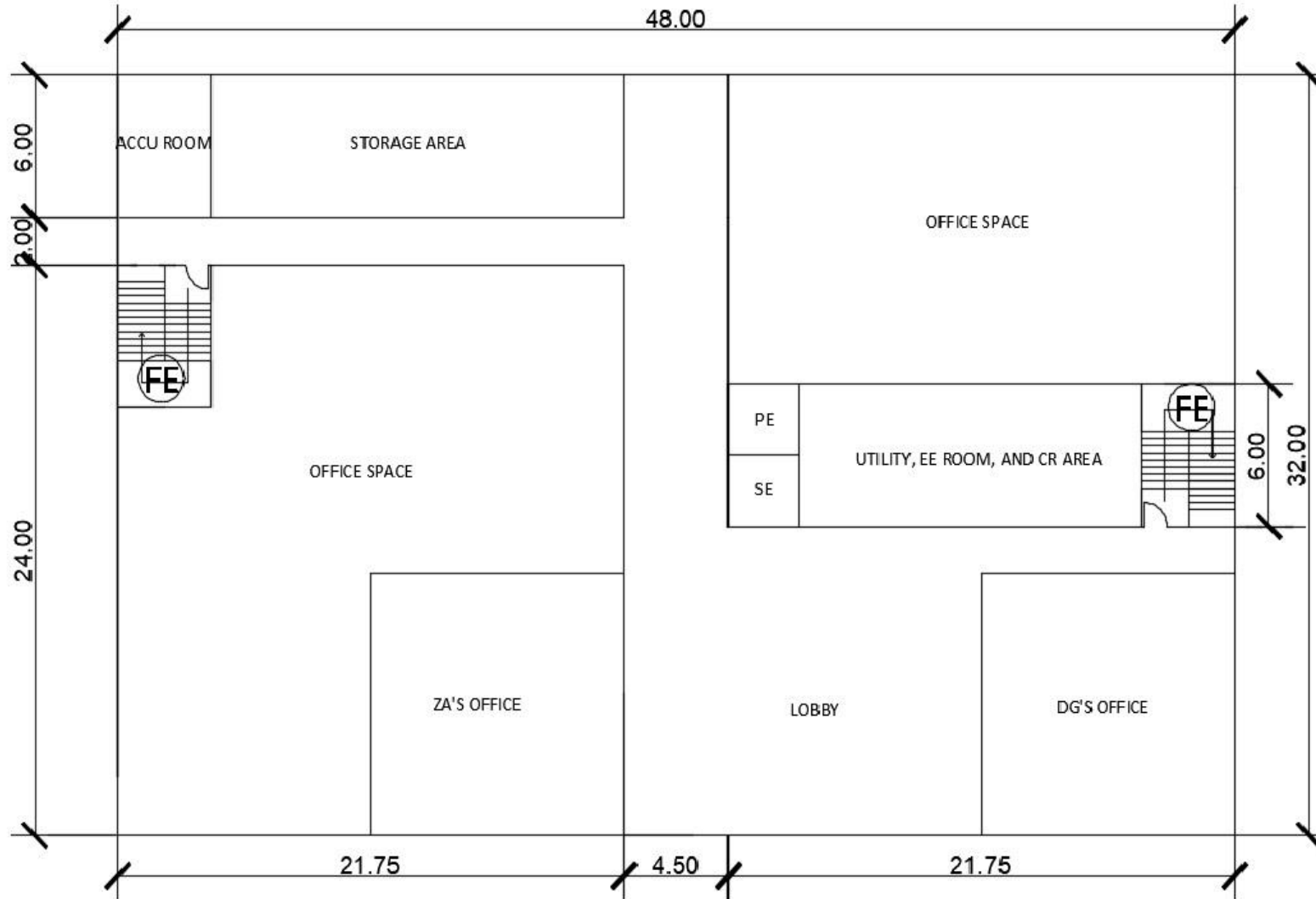

"ANNEX 1" 4TH FLOOR/ROOF DECK PLAN

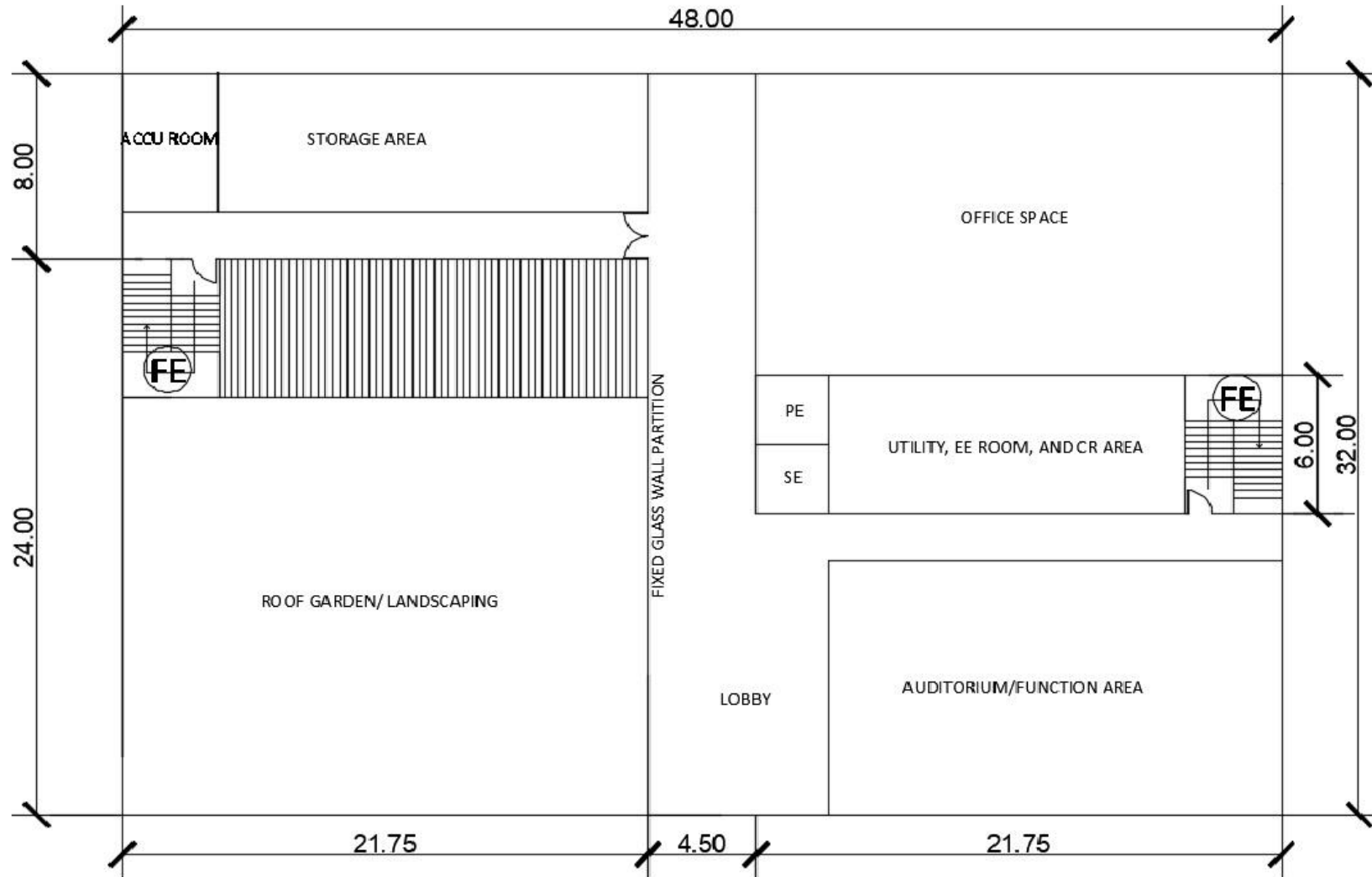

“ANNEX 1”

PEZA BUILDING ROXAS BLVD., PASAY CITY

NOTE: THE PROPOSED
MEZ ADMIN BUILDING
SHOULD JIVE WITH THE
DESIGN OF PEZA
BUILDING LOCATED AT
ROXAS BLVD., PASAY
CITY



WINDOW TREATMENTS

Window treatments used to add shading on curtain walls.



LOW-E GLASS

Low-E glass are used to lessen the heat gain in the building.



PERFORATED FACADE

Perforated metal is used on the facade of the parking floors to allow for natural ventilation.



VERTICAL LOUVERS

Large vertical louvers are placed on sides facing southwest and southeast.



PODIUM GARDEN

Green space integrated into the building.



VERTICAL WAVE LOUVER

Used on the right side of the parking floor for natural ventilation.



DESIGN FEATURES

“ANNEX 1”

PEZA BUILDING
ROXAS BLVD., PASAY
CITY

NOTE: THE PROPOSED
MEZ ADMIN BUILDING
SHOULD JIVE WITH THE
DESIGN OF PEZA
BUILDING LOCATED AT
ROXAS BLVD., PASAY
CITY



“ANNEX 1”

The proposed office building shall be the permanent home of MEZ. The design aims to provide a **safe space** that would contribute **positive impact** to the environment. More than promoting and supporting the country's economy through its intended function, the design of its new facilities aims to support the built environment through **sustainable** approach while increasing productivity of its users through its upgraded facilities.

As the government agency is set to transfer and proceed with its operations, PEZA will continue sailing through the challenges it may face in its day-to-day activities and will thrive through time.